



**BISHOPSTOWN**  
Lawn Tennis Club

Lawn Tennis Club  
**BISHOPSTOWN**

# BLTC - Development Update

Eoin Breathnach

Mar 20th 2024

# BLTC Phase 2 - Courts 2 & 3

## Communications

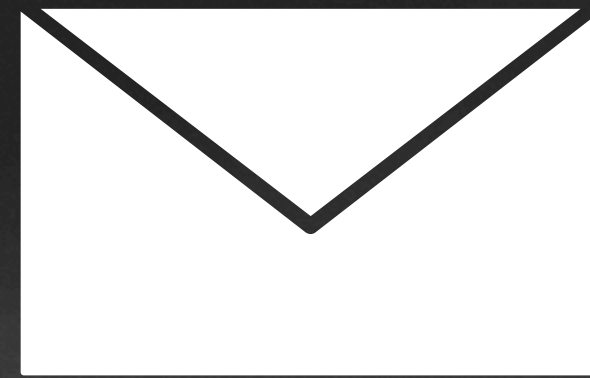

Email & Noticeboard

## Safety

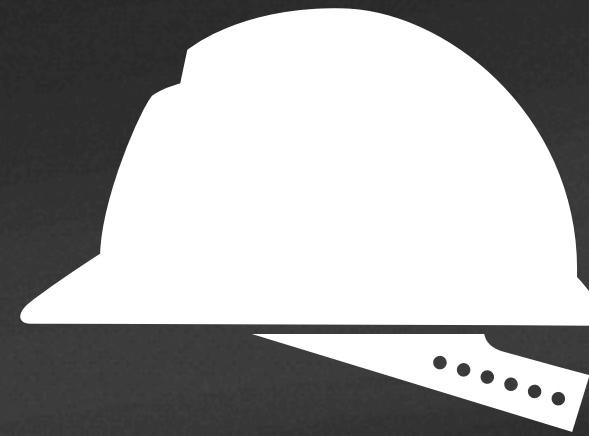

## New Courts



# BLTC Phase 2 - Courts 2 & 3

Court Redevelopment Update: Notice of temporary closure to courts two and three and safety access to courts four, five and six Inbox x

**B** Bishopstown lawn tennis club [via bltc3@mailjet.com](mailto:bltc3@mailjet.com)  
to me

Dear members,

After the successful completion of Phase One of our Club Redevelopment Programme (court one and new lights) in late 2023, we are now about to commence Phase Two of our plan.

We appreciate your patience as we navigate the various elements around the plan but it will all be for a good cause as we can look forward to six brand new courts by the summer.

The work on the redevelopment of courts two and three will begin at 9am on Monday 25th March and it is expected that this work will take **three weeks** to complete. Once completed we will have two more new courts for you to enjoy. In the event that works are completed ahead of schedule, and subject to safety requirements being met, the courts may be open earlier and this will be communicated should this happen.

Please find below a list of key points. We would ask you, as members, to read carefully. Our primary goal is to ensure safety for all members as the redevelopment works start on courts two and three and we want to ensure the successful delivery of new best in class tennis courts for you. To do this the company completing the work, Court Care will require space to complete their contracted works.

**Key points to be aware of:**

**Safety:**

1. From **Monday 25th March** there will be new cordoned off access routes to court one and courts 4,5,6 (see map). This means that we will be asking you to follow the directions which will be laid out on how to get to these courts.
2. Also from that date there will be new site/machinery access to courts two and three (see map)
3. Large machinery will be used throughout the works therefore we need all members to adhere to the new access layouts and to ensure juniors are informed of the new access protocols.

**Court Closure:**

1. **Courts two and three will be closed for access and bookings from Monday March 25th to Friday April 12th**
2. Court one will be closed for access and bookings on March 25th and 26th to allow for replacement of fencing between courts one and two.

**Court Bookings during this time**





Please bear in mind court availability for all members will be reduced while works are in operation. We would encourage members to pre book no more than three hours per week during this time to ensure all members have a fair chance of playing during court redevelopment works. Of course there will be no issues booking a court on the day if there are no pre bookings for certain time slots. Again, can we just take this opportunity to remind members that courts should only be booked under the names of the people using the courts.

**If you have any questions:**

We are planning to host a zoom meeting to answer any questions you may have in advance of Phase two works. This zoom will be held on **Wednesday March 20th** and we will send more details closer to the time.

Again thank you for your patience but these are exciting times ahead for our club as we draw closer to the completion of the redevelopment project.

# BLTC Phase 2 - Courts 2 & 3

-  New Walkways during construction period taped off
-  Site Access
-  Clearing & levelling site
-  New Gate
-  No Parking on Road

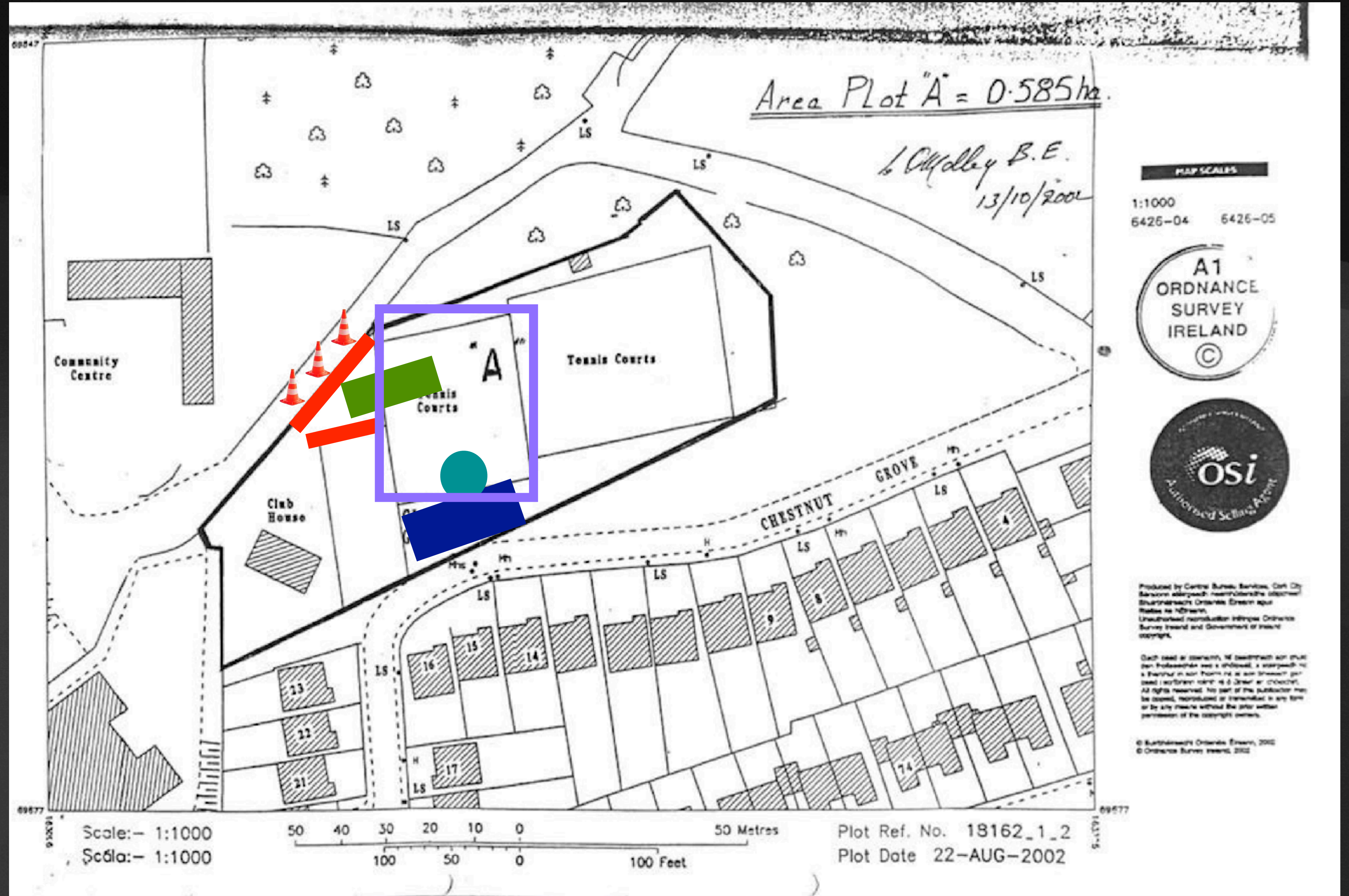





# BLTC Phase 3 - Courts 4,5,6 (Update in April)

Pending new grant approval & quotation



Resurfacing ball wall area with same surface as courts, mini court. Extending to green line on drawing. Adding net for mini court.



Tarmacing grass areas. Lower maintenance and options for kids/ adult fitness areas (longer term) More viewing area



New low maintenance bedding areas around the perimeter wall

